

# PRODUCT SPECS

## Specification

Battery Type	: Rechargeable Lithium Ion
Power Supply	: USB-C
Operating Temp	: -4°F to +140°F or -20°C ~ +60°C
IP Rating	: IP66
Body Material	: ABS (Plastic)
Shackle Material	: Hardened Steel & Rubber
Weight	: Approx. 80g

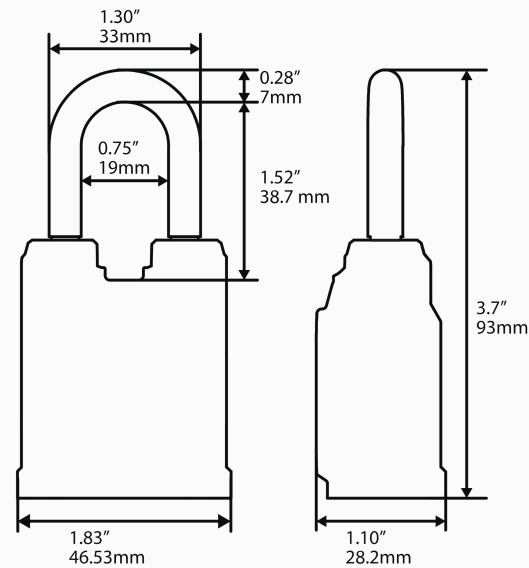

Keyless



Bluetooth



NFC Unlock  
(Model : GT5400 Series)



Directional Code  
(Model : GT5200 Series)



IP66 Weatherproof



Rechargeable  
(USB-C)



Enable by Mobile  
and web app



OSHA-Compliant

eGeeTouch

## PADLOCK MODELS & ACCESSORIES



## GLOBAL & REGION SALES OFFICES



**Digi-Pas® USA (Americas)**  
DIGIPAS TECHNOLOGIES INC  
info@egeetouch.com



**Digi-Pas® UK (Europe)**  
info@digipas.co.uk



**Digi-Pas® Germany (Europe)**  
info@digipas.de



**Digi-Pas® Japan**  
JSB Tech Japan co, Ltd  
info@digipas.co.jp



**Digi-Pas® Singapore**  
JSB Tech Pte Ltd  
info@digipas.com

INTERESTED DISTRIBUTORS OR RETAILERS  
ARE WELCOME TO CONTACT US

DIGIPAS TECHNOLOGIES INC.  
**www.egeetouch.com**

200 Spectrum Center Drive, Suite 300,  
Irvine, CA 92618 U.S.A  
info@egeetouch.com | +949 558 0160



Like us on  
[www.facebook.com/egeetouch](https://www.facebook.com/egeetouch)



Visit our  
[www.youtube.com/egeetouch](https://www.youtube.com/egeetouch)

JFL-5-05X05-9X-02

Note: Specifications may be subjected to change without prior notice.

eGeeTouch®  
A division of DIGIPAS group

## PATENTED SMART LOCKOUT TAGOUT PADLOCK



One Smart LOTO  
Replaces Multiples  
Old LOTO



©DIGIPAS TECHNOLOGIES INC.



## eGeeTouch® LOTO Smart Lockout Tagout Padlock Revolutionizing Safety with Smart Access

The eGeeTouch® Smart LOTO Padlock offers advanced safety solutions with Unique Directional Code or Bluetooth access via the eGeeTouch® apps (Free, Commercial, and LOTO). Whether you're transitioning to digital or maintaining existing processes, eGeeTouch® ensures efficient field safety management.

- **OSHA Compliant** : Meets industry safety standards for lockout/tagout procedures.
- **Easy Access** : Unlock quickly with a NFC Tag or Bluetooth. Outdoor Resistance: Waterproof, freeze-proof, and corrosion-resistant.
- **Multiple Layers of Security** : Up to 8 levels of authorization and encrypted IDs.
- **Audit Trail** : Track who, when, and where the padlock was accessed

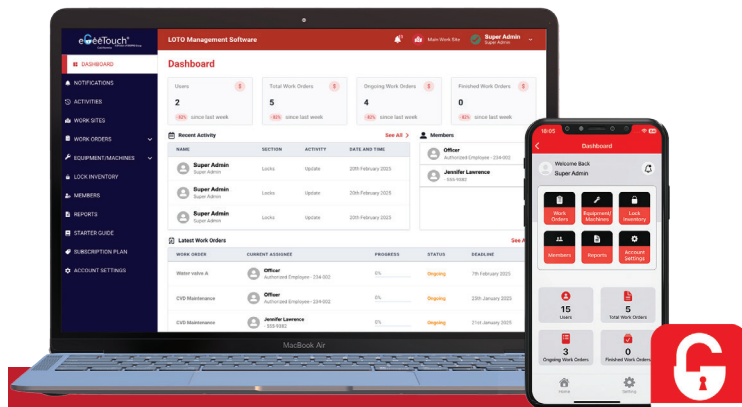

## Ready to Go Fully Digital? Unlock Smarter Safety with eGeeTouch® eLOTO Software

Enhance your lockout/tagout procedures with eGeeTouch's digital safety management software. Streamline your workflow, ensure compliance, and improve workplace safety with easy-to-use features:

- Create Work Orders
- Automated Notifications
- Real-Time Tracking
- Mobile app + PC web based system
- Data digitally stored digitally, eliminating the need for paperwork.
- Generate reports easily to ensure compliance and safety records are always up to date.
- Manage your lockout/tagout processes efficiently and securely from any device.

## APPLICATION

### Pneumatic Equipment Lockout

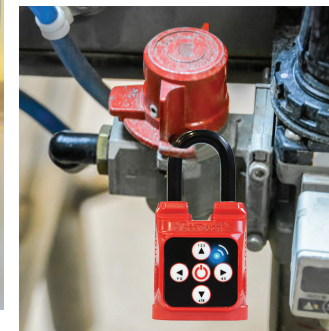

### Electrical Power Lockout



### Gas & Liquid Pipes Valve Lockout



### Machine/Equipment Lockout

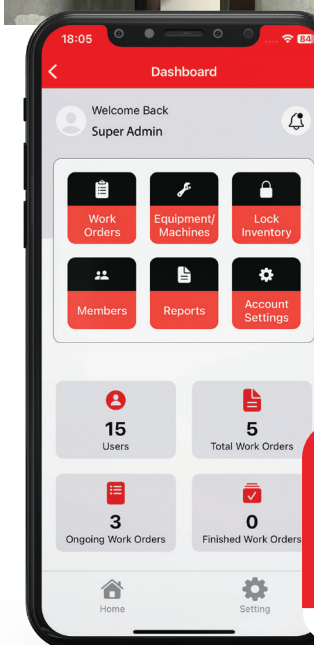

**SMART LOTO AVAILABLE**



**SMART LOTO**